

STEELMATE®

Think about safety think Steelmate

Honesty Innovation Passion



Steelmate Co., Ltd.

<http://www.steel-mate.com>

E-mail: sales@steel-mate.com

All rights reserved

The trademark, patent and copyright are owned by Steelmate Co., Ltd.

The right to change designs and specifications for improving the product is reserved



PARKING ASSIST SYSTEM

Footbrake activated function

2 sensor system can be upgraded to 4 sensor system

PTSF400

For 2 or 4 sensor front parking system



Top 8 reasons to choose Steelmate

1. Professional manufacturer with high quality standards.
2. Complete range of products, you can easily select a product to match.
3. There are agents/distributors in more than 80 countries to supply local service.
4. More than 100 engineers in the company, you can enjoy the latest technology.
5. More than 300 patents.
6. Products have international approvals, high quality guaranteed.
7. Leading manufacturer in automotive industry, ISO 9001, ISO/TS16949 and ISO 14001 certified.
8. Leading brand in China. Recognized worldwide.

Important notice

Steelmate parking assist systems help to provide assistance when reversing and parking. Driving skills, such as slowing down, use of mirrors etc. is always essential.

1. This unit is for vehicles with 12V DC only.
2. Unit should be installed by a professional auto technician.
3. Route wiring harness away from heat sources and electrical components.
4. It is strongly recommended to check the position of the sensors before the actual drilling of the holes.
5. Perform test after the installation.

About the product

This front parking assist system is an ultrasonic monitoring system. It electronically detects the area in front of your vehicle while parking, and alerts you with different warning sounds. It assists the driver when parking and driving in tight space situations.

Every part of our products has passed the most stringent test before releasing to the market. It can operate at a wide temperature range (-40°F~+176°F / -40°C~+80°C) and has good stability in all weather conditions.

Steelmate's parking assist system will result in an increased level of control during your driving and parking.

Key features

- 1 Front system with four sensors and one buzzer
- 1 Designed for front bumper protection
- 1 Metal ECU, anti-interference
- 1 Self-testing function
- 1 Can be used for car with OEM rear PTS
- 1 Detachable sensor with waterproof wire connector
- 1 Easy installation
- 1 All weather design (-40°F~+176°F / -40°C~+80°C)

Technical parameters

- 1 Operating Voltage: 10V~16V
- 1 Frequency: 40KHZ
- 1 Input Current : <250mA
- 1 Buzzer Volume: 70~90dB
- 1 Working Temperature: -40°F~+176°F / -40°C~+80°C

How does the system work

Self testing

Insert the key and turn it to ACC ON, the system will test all the sensors automatically.

1 If all the sensors are functioning, the system will not beep.

1 If there is any problem with the sensors, the system will beep three times to indicate that one or more sensors are damaged.

How does the system work

Insert the key and turn it to ACC ON, once the footbrake is pressed, the system will be activated automatically, and the sensors will start detecting. If the obstacle appears in the detecting range, the system will alert the driver with different warning sounds according to different distance. When the distance of the obstacle detected is not changed, the system will stop beeping in 5 seconds. Once the distance of the obstacle begins to change, the system will beep again.

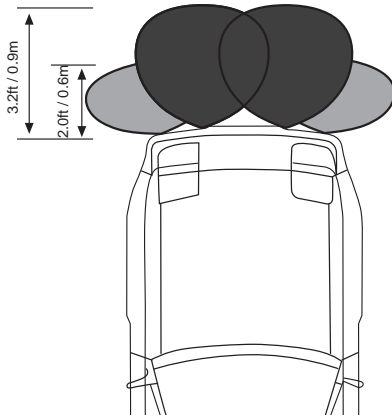

Alert mode (for system with 4 sensors)

Alert stages	Distance range	Warning sound
1st stage	3.2~2.0ft/0.9~0.7m	Be--Be--
2nd stage	2.0~1.3ft/0.7~0.4m	Be-Be-Be-Be
3rd stage	1.3~1.0ft/0.4~0.3m	Be— Be—
4th stage	<0.3m	Be————

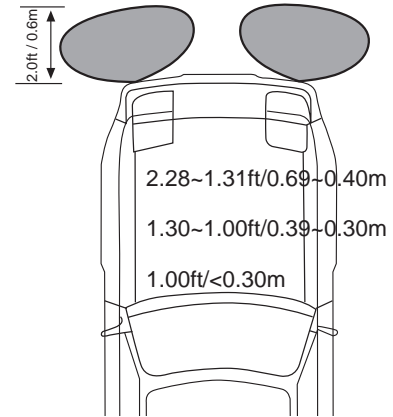

Alert mode (for system with 2 sensors)

Alert stages	Distance range	Warning sound
1st stage	2.2~1.3ft/0.6~0.4m	Be-Be-Be
2nd stage	1.3~1.0ft/0.4~0.3m	Be— Be—
3rd stage	<0.3m	Be————

Installation diagram

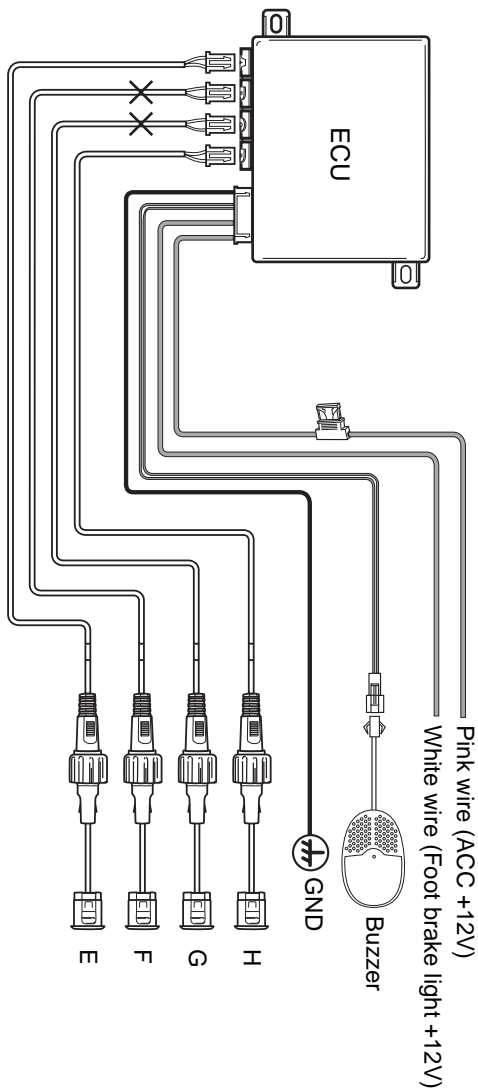
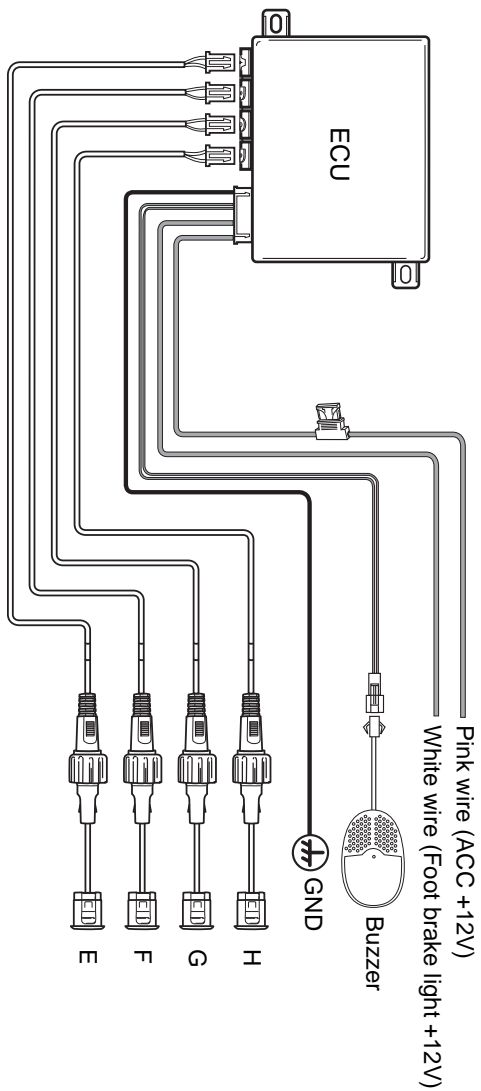

Sensor Installation

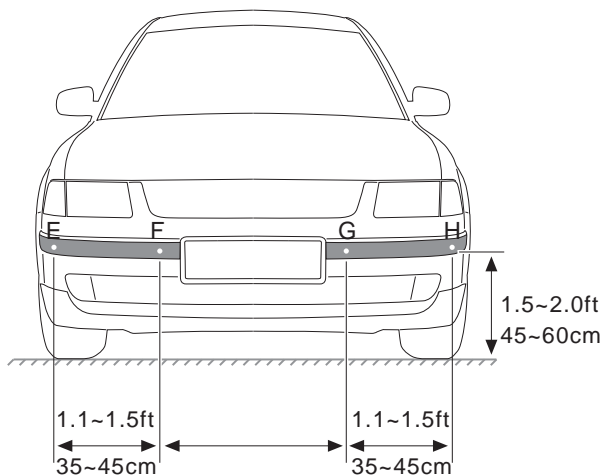

The sensors should all be installed on the same horizontal plane.

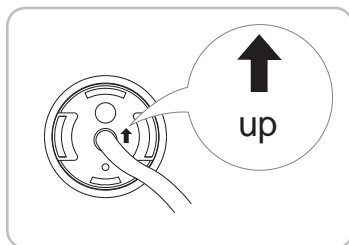

1. Install the sensor vertically, the "up" sign must be on upside.

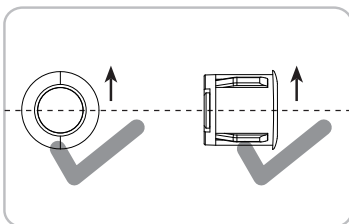

2. The sensors should be installed at a 90° angle with the ground.



3. Select a smooth surface area which is 1.5~2.0 ft/45~60cm to the ground as the horizontal guideline.

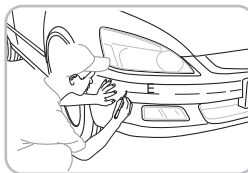

4. Select a smooth surface area on the left and right side of the car along the horizontal guideline for E and H sensor.

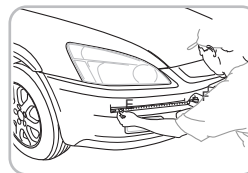

5. Along the horizontal guideline, select a smooth surface area which is 1.1~1.5ft / 35cm~45cm away to E sensor for F sensor and 1.1~1.4ft / 35cm~45cm away to H sensor for G sensor (for 2 sensor application do not install F and G sensors).

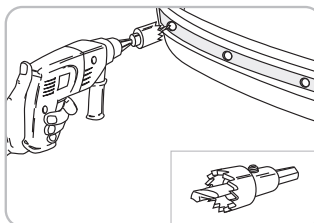

6. Check the size of the hole saw to be matching the diameter of the sensors before drilling any holes.

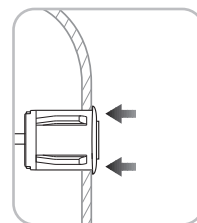

7. Insert the sensor and press into the hole firmly.

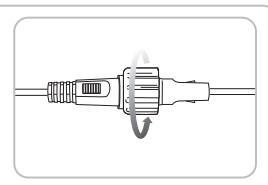
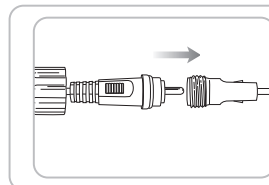

8. Insert the plug into the socket and turn the sealing screw cap tightly.

※ Note: The sensor shown above maybe different from the product.

Attention

False detection may occur in the following situations:

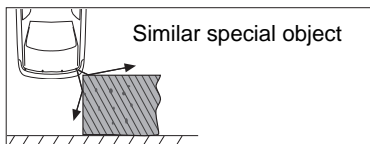
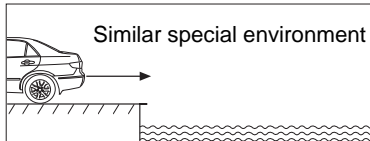
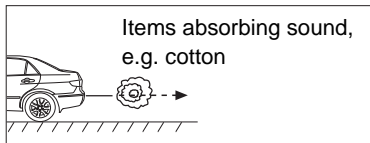
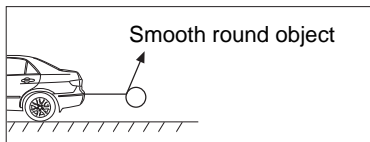
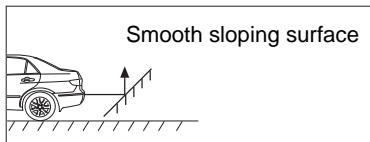

- 1 After installation, fully test the system before use.
- 1 Heavy rain, dirt or a damaged sensor can cause incorrect detection.
- 1 Ensure that the self-testing function is complete and indicates no malfunction before driving.

The product is a driver assistance device. No warranty as to the operating efficiency of the system or prevention of accidents is guaranteed.

Troubleshooting

1. The system does not work after installation.
 - 1) Is the power supply wire connected correctly?
 - 2) Is the ignition turned to ACC ON?
 - 3) Is footbrake pressed?
 - 4) Are all wiring connections correct?
 - 5) Are the sensors' wires connected to the ECU properly?
2. The system indicates defective sensors
 - 1) Check if the sensor surface is clean
 - 2) Check if the sensor wires are plugged in the ECU properly
 - 3) Check if the sensor wires are damaged
3. False reading from the buzzer
 - 1) Are sensors mounted too low?
 - 2) Are sensors detecting the ground?
 - 3) Unplug one sensor at a time to check for response

Warranty

I. The unit is warranted for a limited period from the date of purchase. In the unlikely event of a defect arising in this product when used in accordance with the manufacturer's instructions, the parts would be repaired or replaced free of charge.

I You (the customer) are required to show warranty card when making any warranty claims.

I The model and serial number on unit must be the same as the information on the warranty card.

II. This warranty is non-transferable and is automatically void if:

I The original purchaser has not completed the warranty card.

I The unit's serial number is defaced, missing or altered.

I The unit has been modified or used in a manner contrary to its intended purpose.

I The unit has been damaged by accident, unreasonable use, neglect, improper installation or service.

III. The warranty does not cover damage to the unit caused by installation or removal of the unit.

STEEL MATE®

STEELMATE WARRANTY CARD

Dear user:

Thank you for choosing "Steelmate" product.
Please fill the form below and retain it.

User's information:

User:

Tel:

Vehicle license No.:

Product model No.:

Series No.:

Date of installation:

Name of the Retailer

Signed by Retailer