

INSTALLATION MANUAL

Unpacking checklist

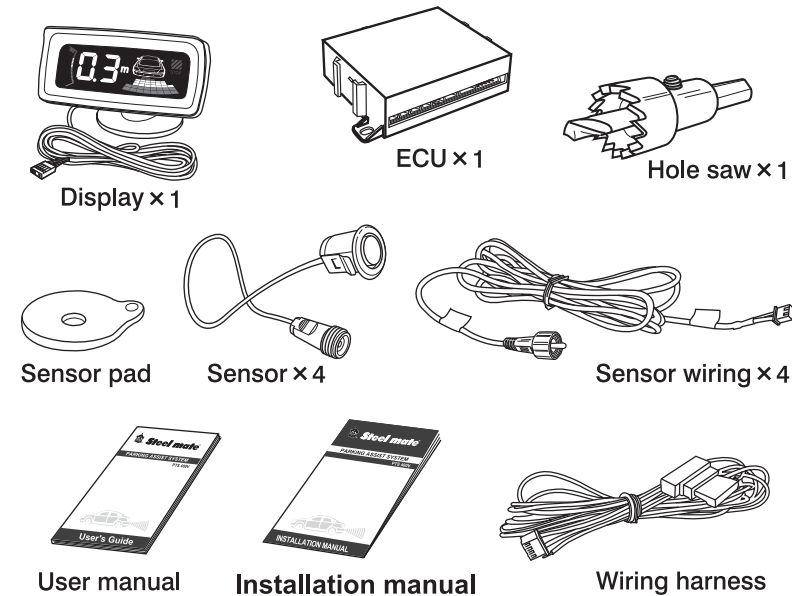

Notes:

1. This unit is for vehicles with 12V DC only.
2. Unit should be installed by a professional auto technician.
3. Route wiring harness away from heat sources and electrical components.
4. Power loom connections should be soldered and insulated.
5. Perform test after finishing the installation.



Manufactured by
Steelmate Co., Ltd.
Http://www.steel-mate.com
E-mail: sales@steel-mate.com

PR0113/A

1. Sensor installation

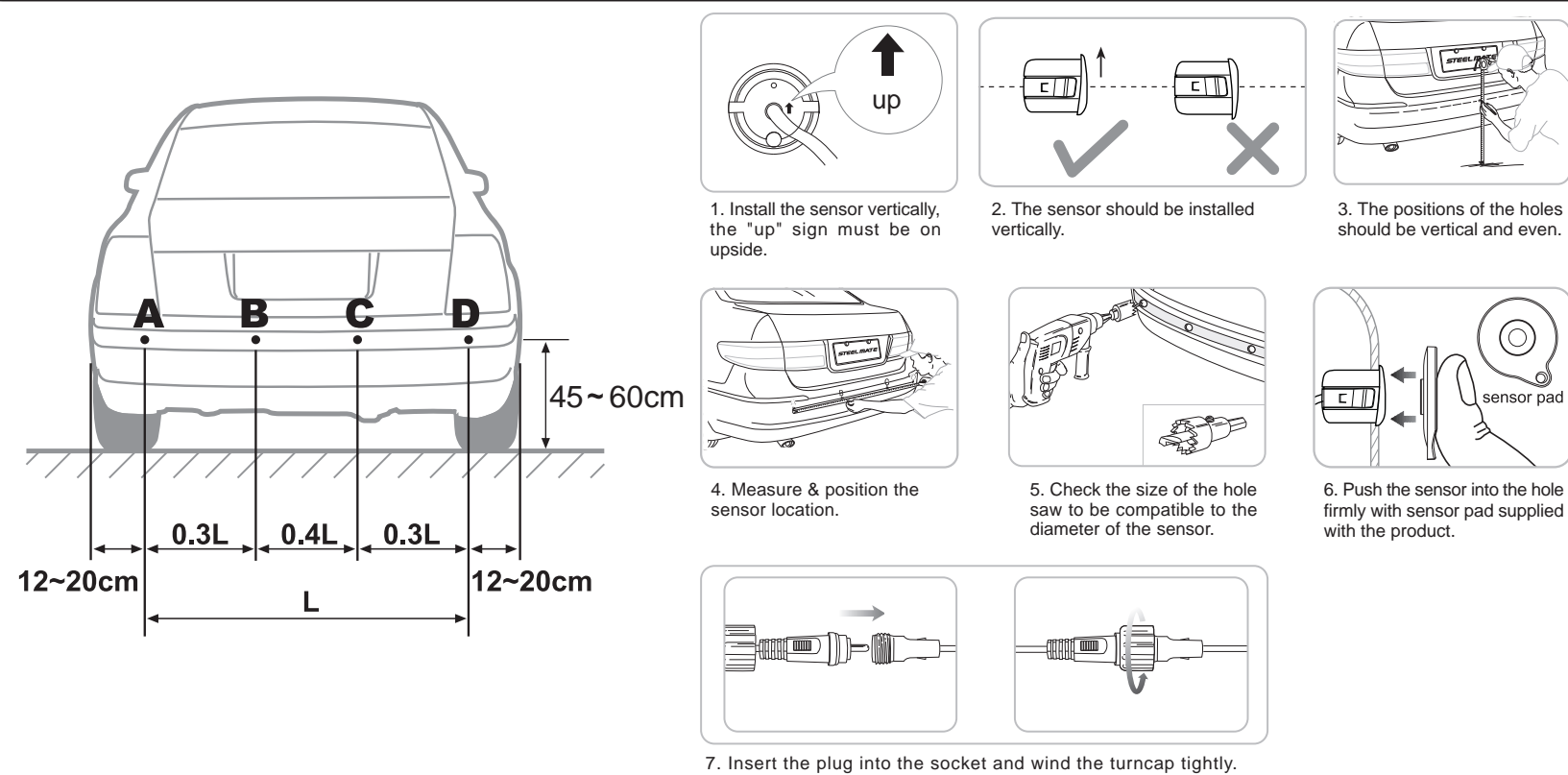

2. ECU installation

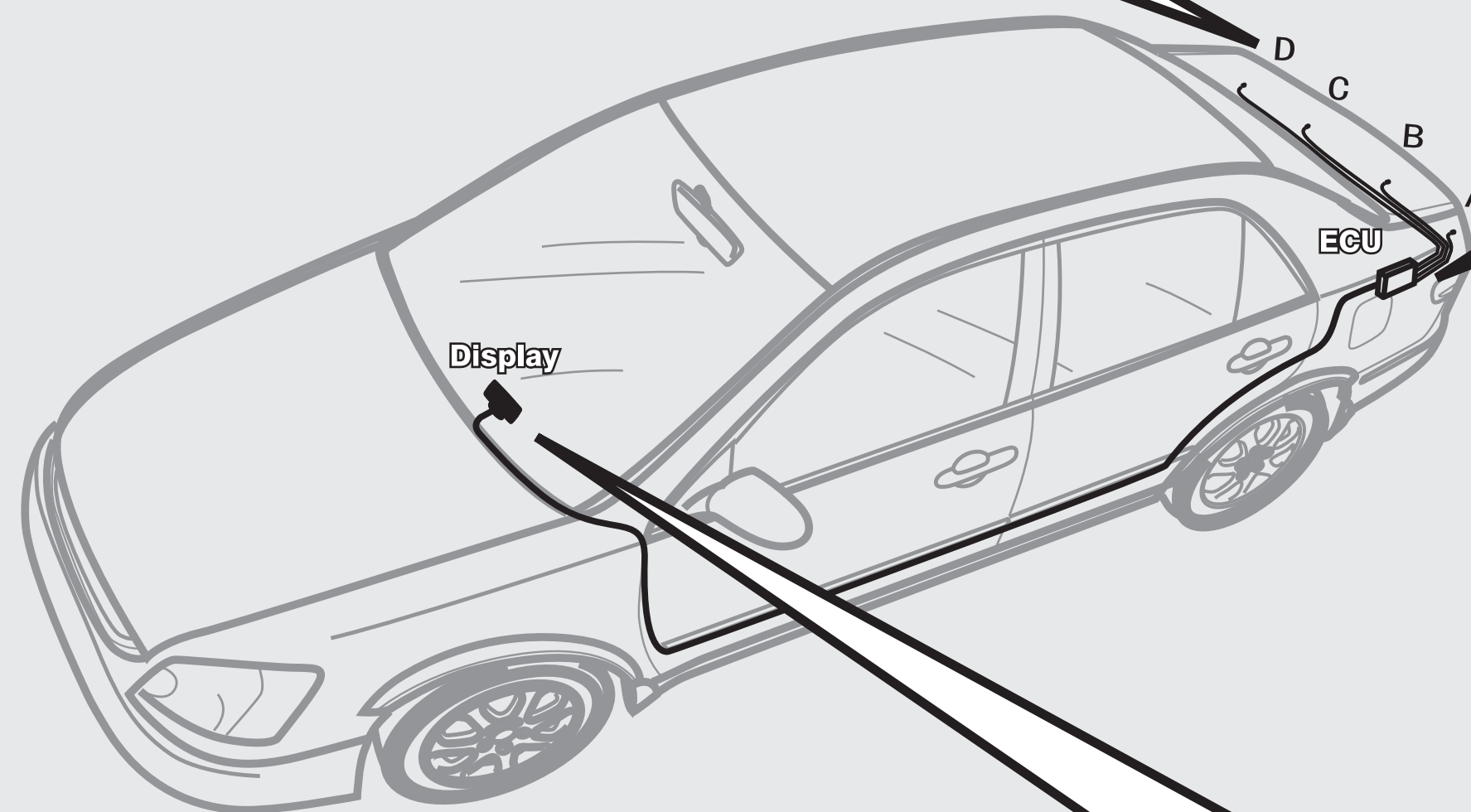
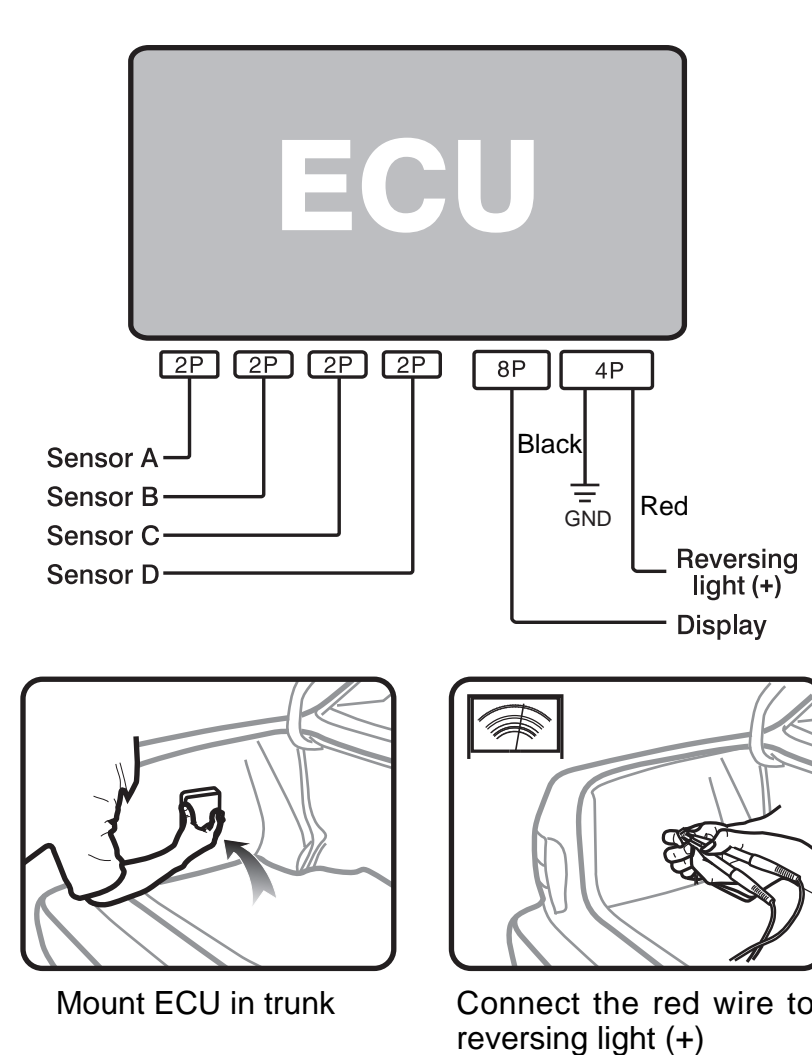

Fix the display in A/C vent using clip provided

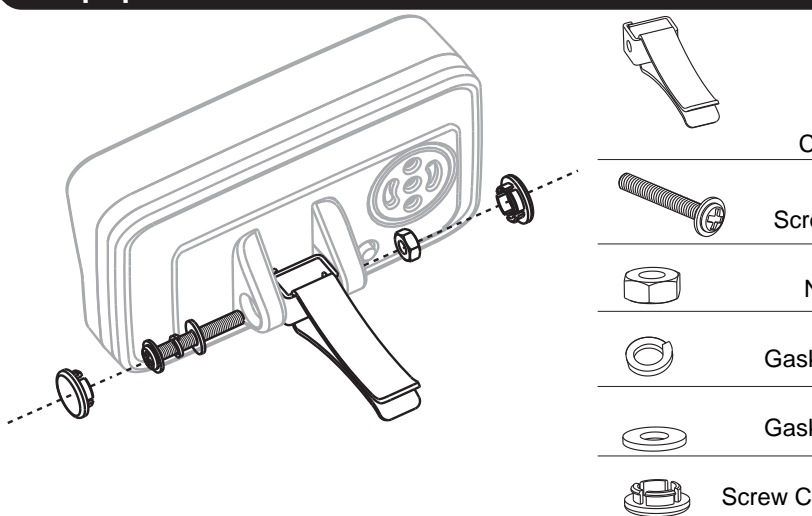

4. Function testing

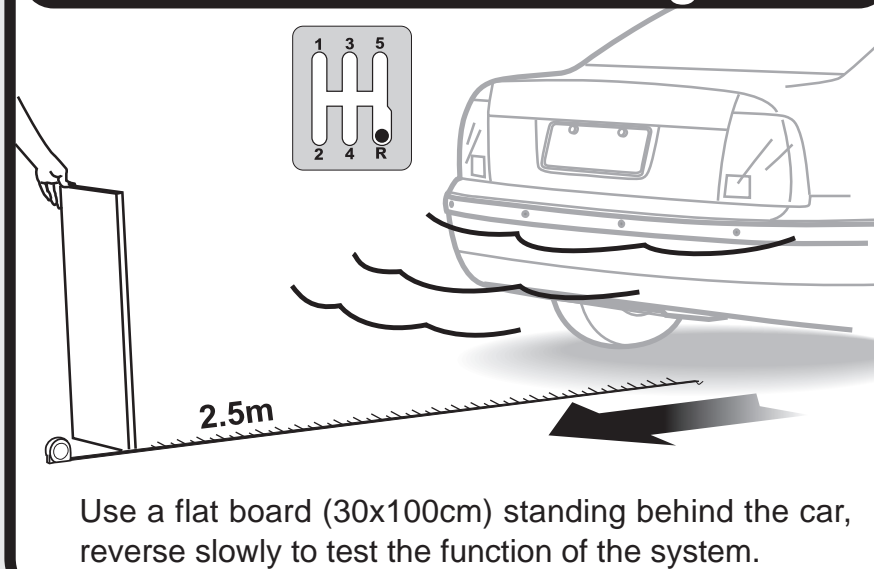

3. Display Installation (Three choices)

